

- 1. 1x V11
- 2. 1x V19
- 3. 1x P32
- 4. 1x P32
- 31. 1x P50
- 32. 1x P49
- 5. 1x P54
- 6. 9x M0511 Ø6
- 7. 9x M0811 3,9x38
- 8. 4x M5974
- 9. 4x M5975
- 10. 4x M5924
- 11. 4x M5925
- 12. 1x M8833
- 13. 1x M8835
- 14. 1x M8834
- 15. 2x M0797 3,5x45
- 16. 1x M0547
- 17. 2x M0793 3,5x25
- 18. 1x M1916
- 19. 1x P3010
- 20. 1x MA0852
- 21. 1x M8169
- 22. 1x
- 23. 1x M8018
- 24. 1x
- 25. 1x M5926
- 26. 1x M5927
- 27. 1x M1896
- 28. 1x M0800 3,5x45
- 29. 1x
- 30. 1x
- 33. 1x M8915
- 34. 1x M8914
- 35. 1x M8921
- 36. 1x M8312
- 37. 1x M0808 3,5x9,5
- 38. 4x M0806 3,5x9,5
- 39. 4x M1907
- 40. 1x M0838 Ø2,8
- 1x M0750

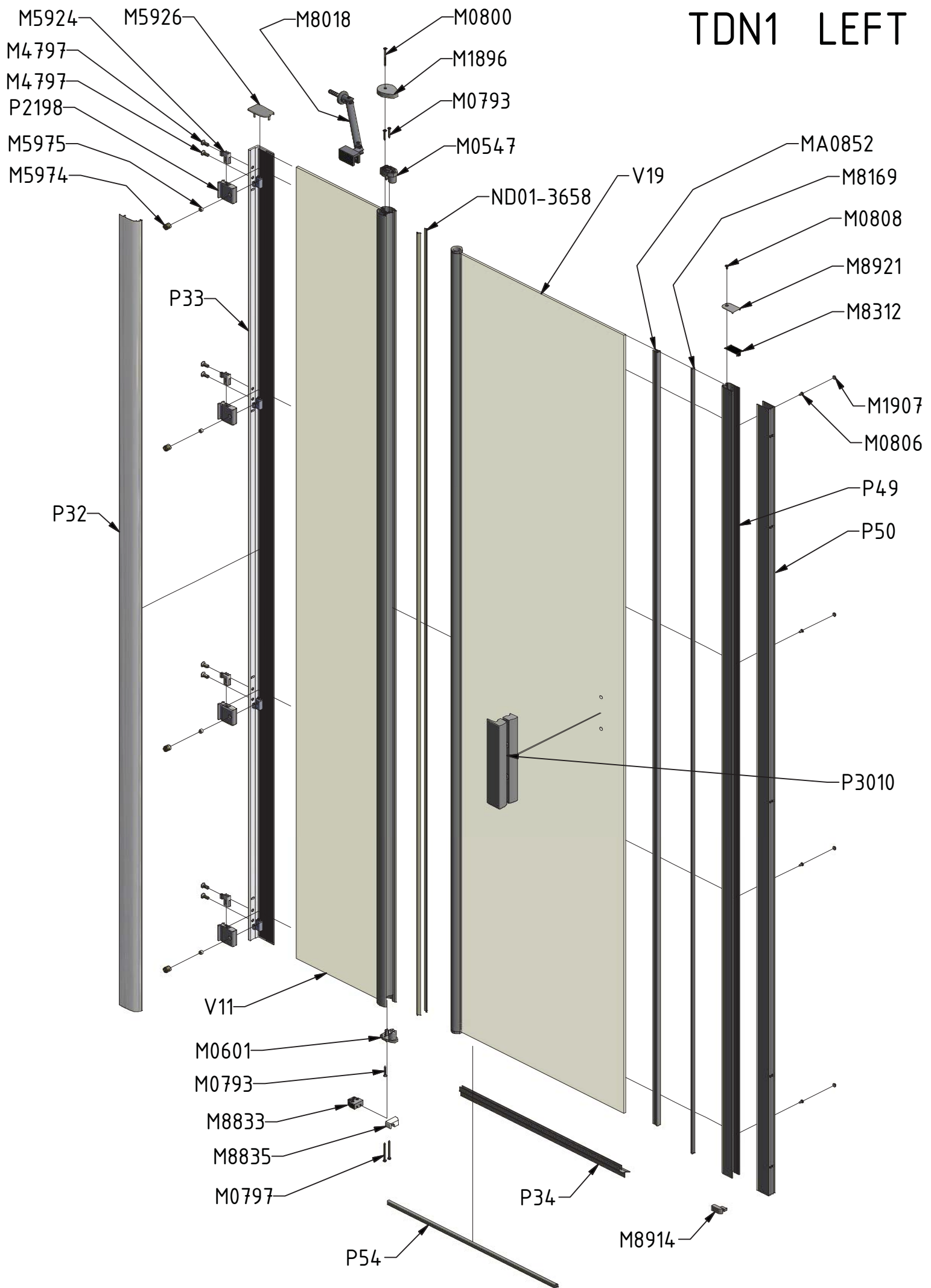

TDN1 LEFT



TDN1 RIGHT

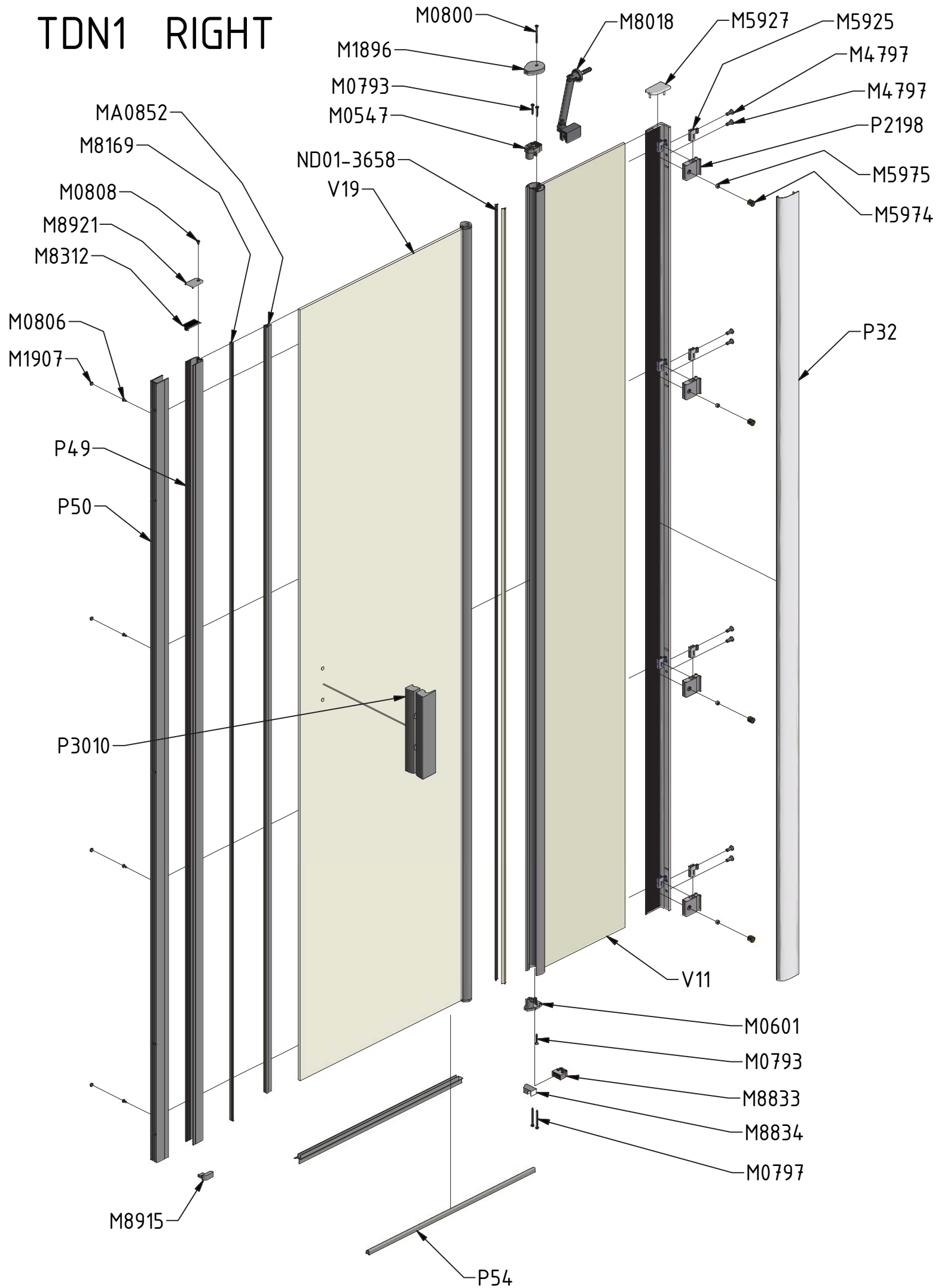

P32		brillant	P2197
		elox	P2205
P33		brillant	ND01-0973-00
		elox	ND01-0973-01
P34			ND01-2420
P49		brillant	P2698
		elox	P2699
P50		brillant	P2700
		elox	P2701
P54	800		ND01-2277-8
	900		ND01-2277-9
	1000		ND01-2277-1

V11	800;900;1000	brillant+clear glass	brillant+ iré sklo	ND03-0198-00-02
		elox+clear glass	elox+ iré sklo	ND03-0198-01-02
V19	800	brillant+clear glass	brillant+ iré sklo	ND02-0517-00-02
		elox+clear glass	elox+ iré sklo	ND02-0517-01-02
	900	brillant+clear glass	brillant+ iré sklo	ND02-0518-00-02
		elox+clear glass	elox+ iré sklo	ND02-0518-01-02
	1000	brillant+clear glass	brillant+ iré sklo	ND02-0519-00-02
		elox+clear glass	elox+ iré sklo	ND02-0519-01-02



ROLTECHNIK a.s. / Třebořov 160 / 569 33,
CZECH REPUBLIC

10

EN 14428:2008+A1