

## REQUIREMENT OF USE & MAINTENANCE

- 2 Please be careful to open the packaging, install and clean products to avoid surface damage.
- 2 Please use water or neutral detergent to clean the surface of products, and then dry them by the soft towel.
- 2 Do not use detergent containing scouring powder, polishing powder, or any corrosive substance, or rough cloth to clean the products
- 2 When you use acidic (alkaline) detergent to clean the objects beside products, it may damage the surface of products, please exercise extra caution.
- 2 To be suggesting cleaning products regularly to maintain the product appearance bright permanently.

## RECOMMENDED TOOLS



IMPACT DRILL

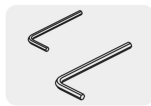

ALLEN KEY

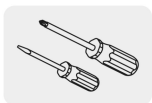

SLOT TYPE SCREWDRIVER  
PHILIP'S TYPE SCREWDRIVER

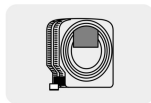

TAPELINE

## INSTALLATION

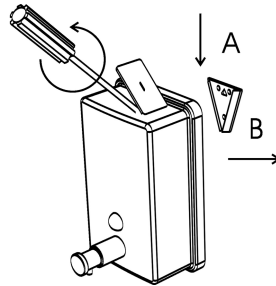

1. Unscrew the set screw inside the back of dispenser, and take out the wall bracket.

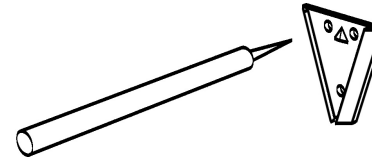

2. Draw the holes on the wall for installing the wall bracket.

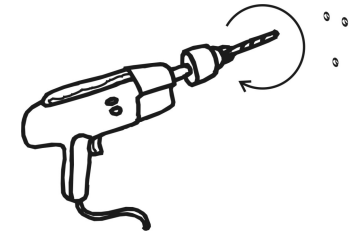

3. Drill the holes for plastic fixing

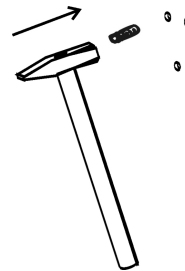

4. Put the plastic fixings in the holes

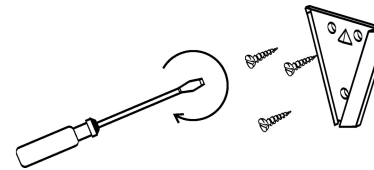

5. Install the wall bracket by screws

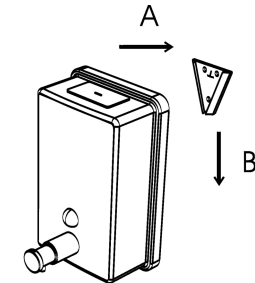

6. (A) Put dispenser in the position of the wall bracket  
(B) Close them together by pressing the dispenser downward

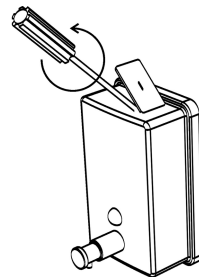

7. Tighten the set screw which inside the back of dispenser.