

A

LAVAL

S474-REG1D1W

| A | B | C | D | |
|----|-----------|------|-----|-----|
| 1 | S474-0006 | 1365 | 376 | 2/2 |
| 2 | S474-0007 | 1365 | 525 | 2/2 |
| 3 | S474-1009 | 1368 | 384 | 2/2 |
| 4 | S474-1010 | 1368 | 384 | 1/2 |
| 5 | S474-1011 | 1426 | 348 | 1/2 |
| 6 | S474-2007 | 963 | 422 | 1/2 |
| 7 | S474-2008 | 933 | 400 | 1/2 |
| 8 | S474-3007 | 518 | 348 | 1/2 |
| 9 | S474-3008 | 369 | 348 | 1/2 |
| 10 | S474-3009 | 368 | 347 | 1/2 |
| 11 | S474-3010 | 517 | 347 | 1/2 |
| 12 | S474-4011 | 369 | 88 | 2/2 |
| 13 | S474-4012 | 369 | 88 | 2/2 |
| 14 | S474-4013 | 902 | 82 | 2/2 |
| 15 | S474-4014 | 1338 | 72 | 2/2 |
| 16 | S474-5001 | 512 | 341 | 1/2 |
| 17 | S474-9004 | 1436 | 382 | 2/2 |
| 18 | S474-9005 | 1436 | 531 | 2/2 |

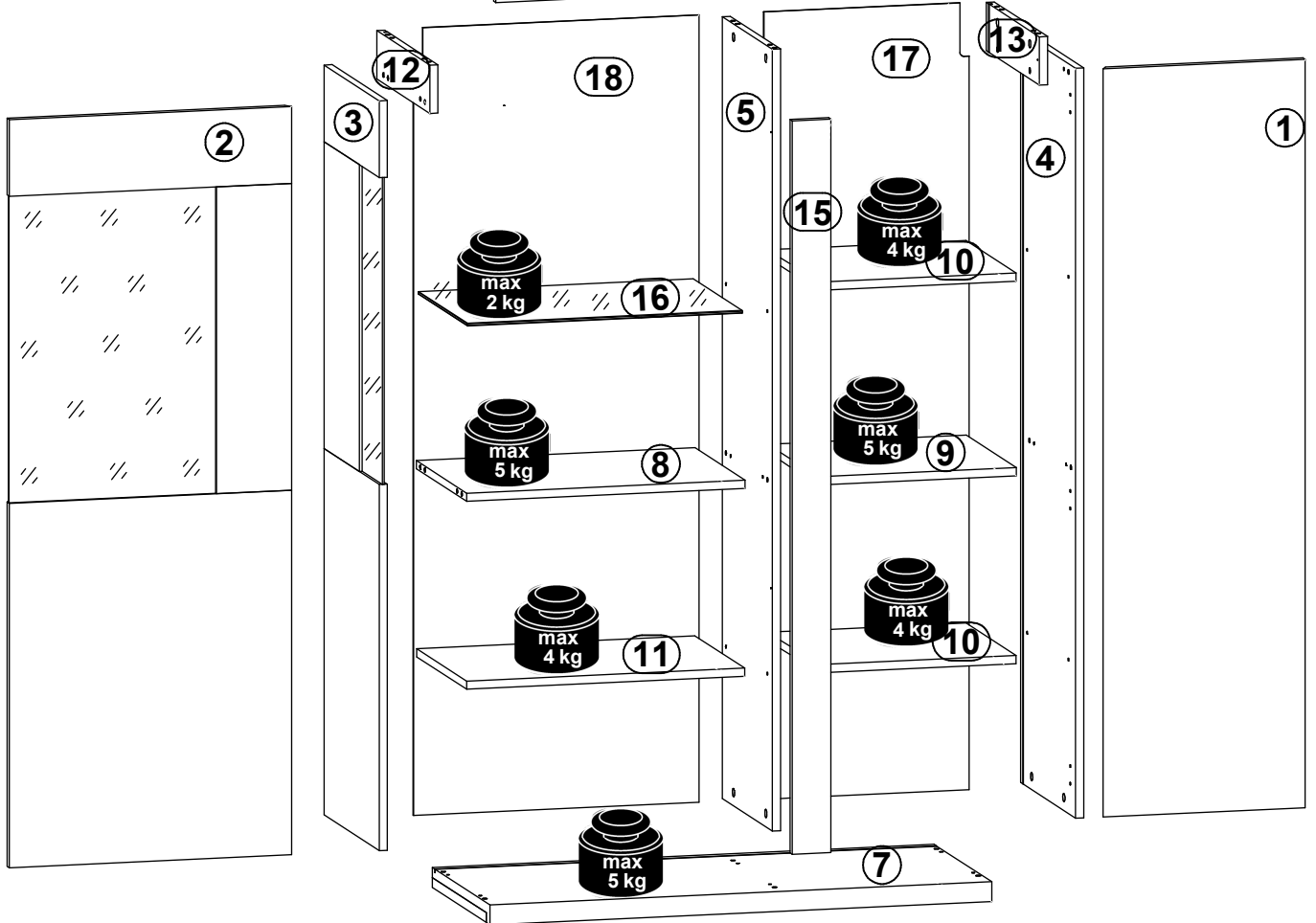
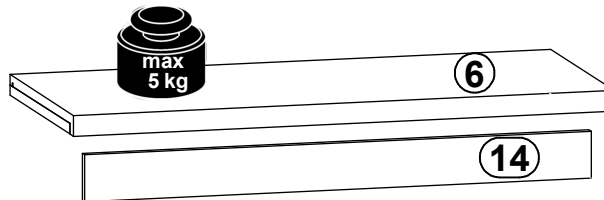
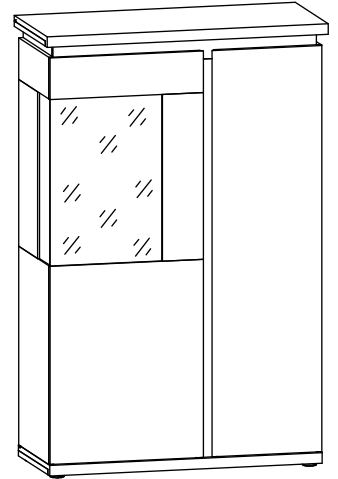
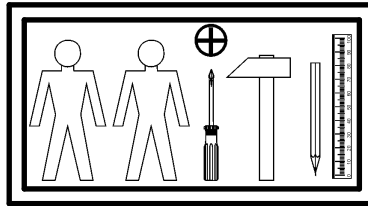

| | | | | | | | | |
|--------------------------|----------------------------|------------------------------|---------------------------|--------------------------------------|-------------------------|--------------------------------------|-------------------------|--------------------------|
| 4x Ø35 a204 | 2x Ø35 a211 | 6x Ø2 b90 | 12x Ø5x17 mm d1 | 4x d33 | 6x d36 | 4x Ø7x28 mm e22 | 20x Ø8x30 mm f1 | 4x Ø8x20 mm f13 |
| 5x Ø48x10 mm k43 | 10x l2 | 7x 22x9.5x20.7 mm n108 | 1x 6P 15W Ø70/22 | 2x L=380 mm 10x10 mm Ø77/23 | 3x 10x18 mm Ø83/9 | 1x L=905 mm 10x10 mm Ø137/3 | 1x Ø3.5x16 mm p38 | 24x Ø3.5x15 mm p51 |
| 12x Ø2.9x16 mm p55 | 20x Ø15x12 mm #16 r1 | 20x Ø20/11 r42 | 4x Ø14x0.5 mm s59 | 20x Ø 20mm s68 | 1x 4 mm z1 | 1x n26/1 | | |

1 

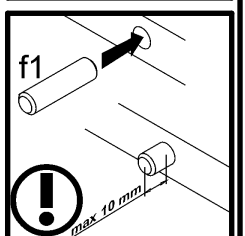
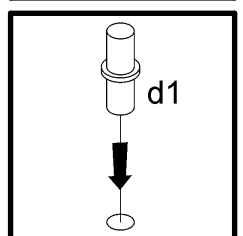
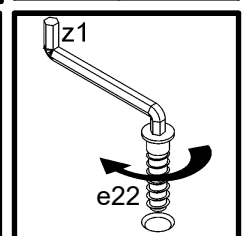
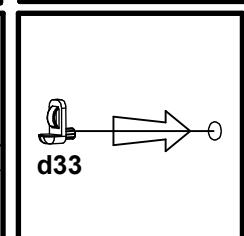
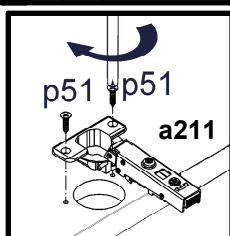
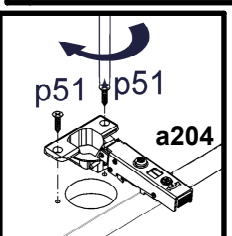
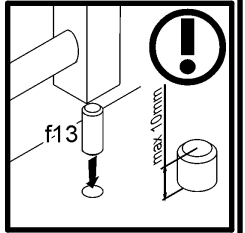
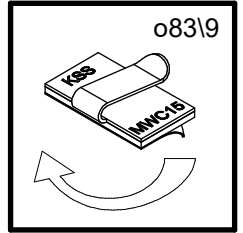
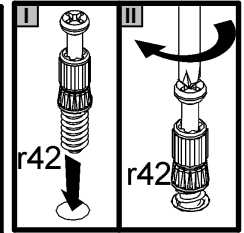
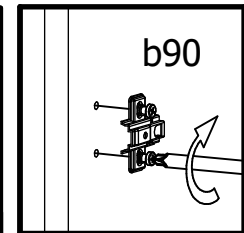
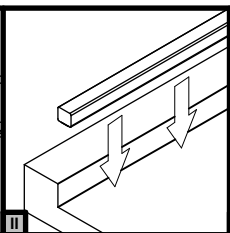
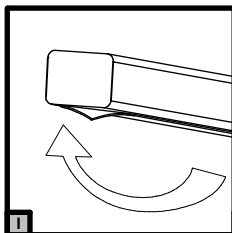
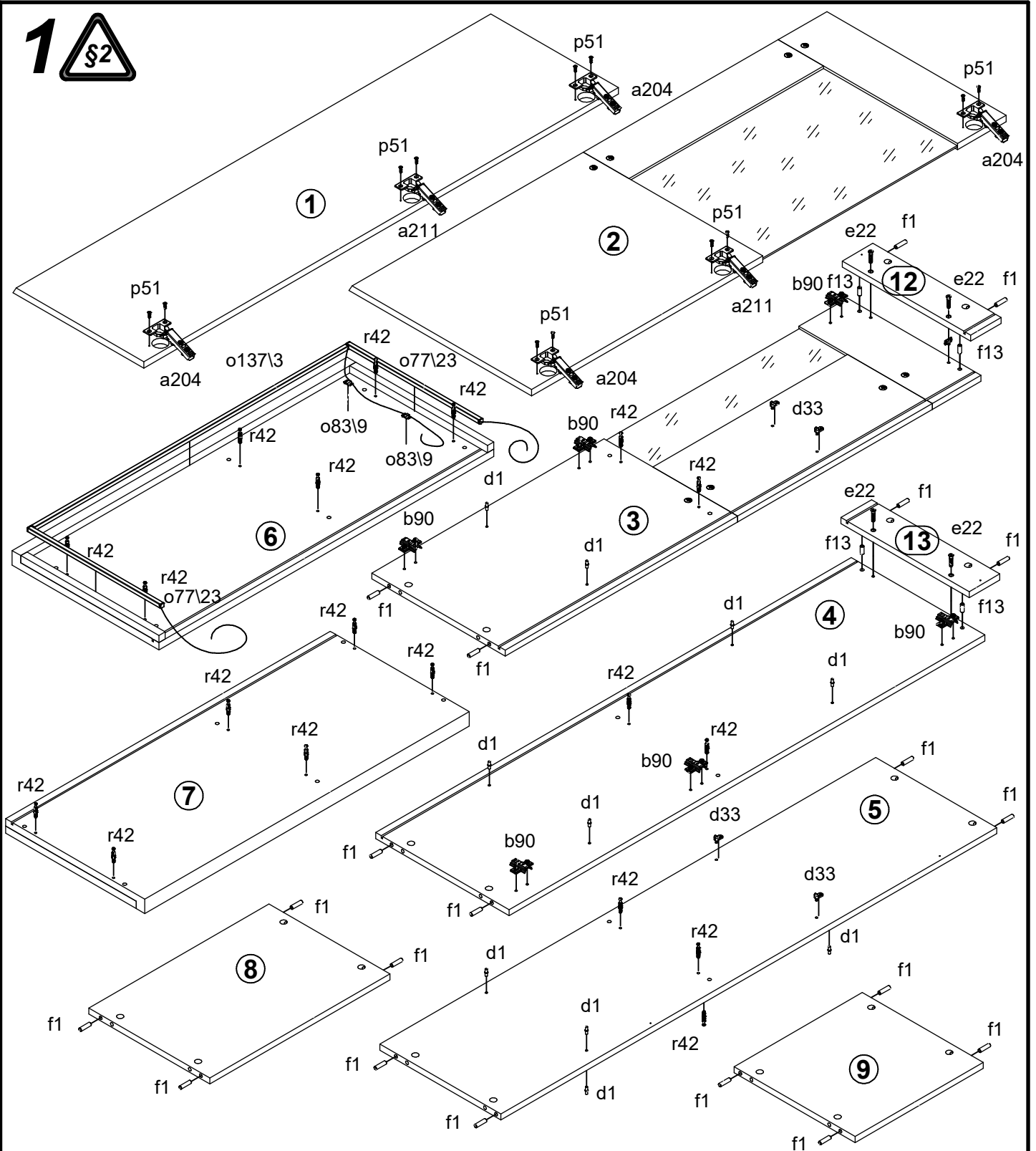

2

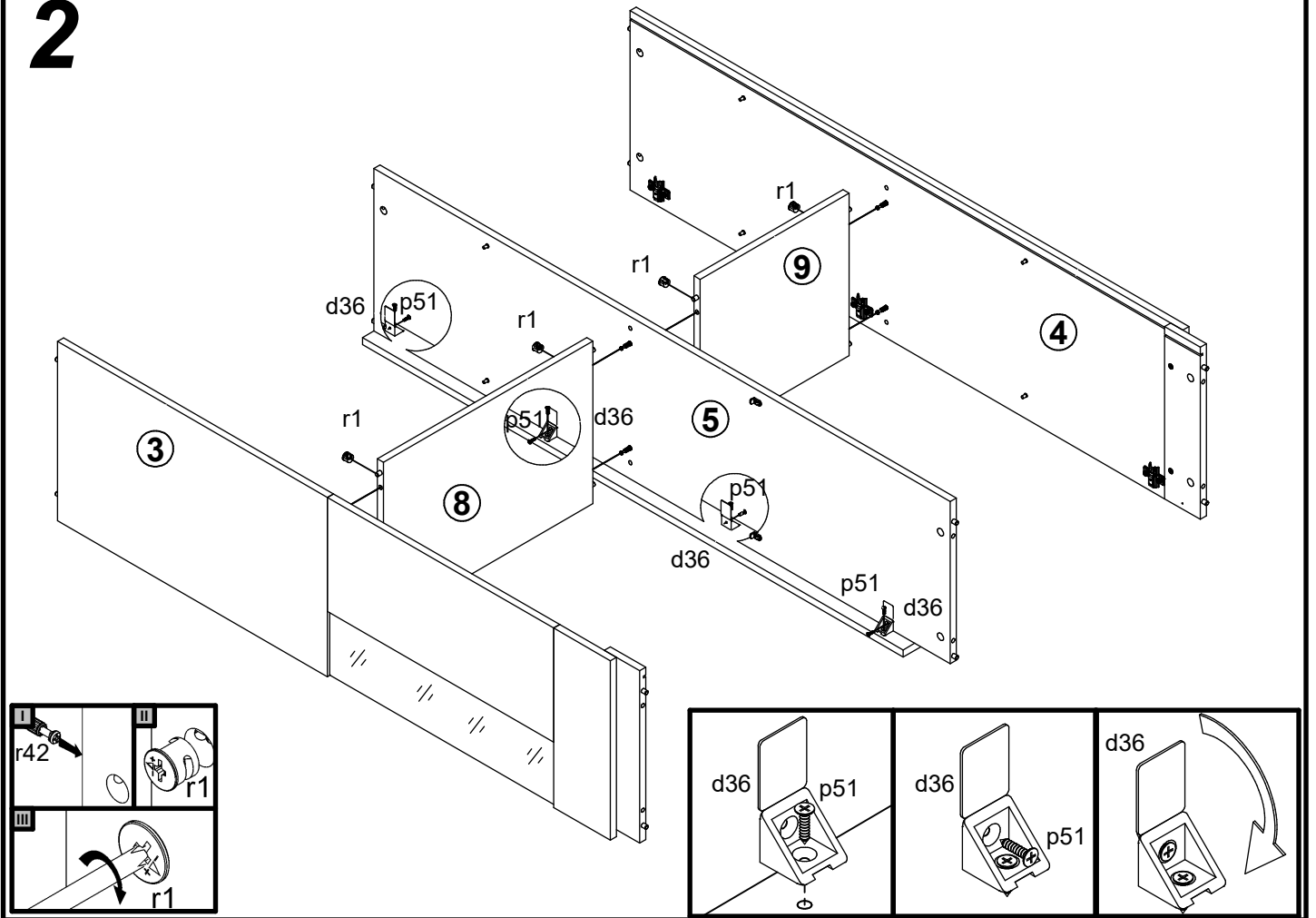

3

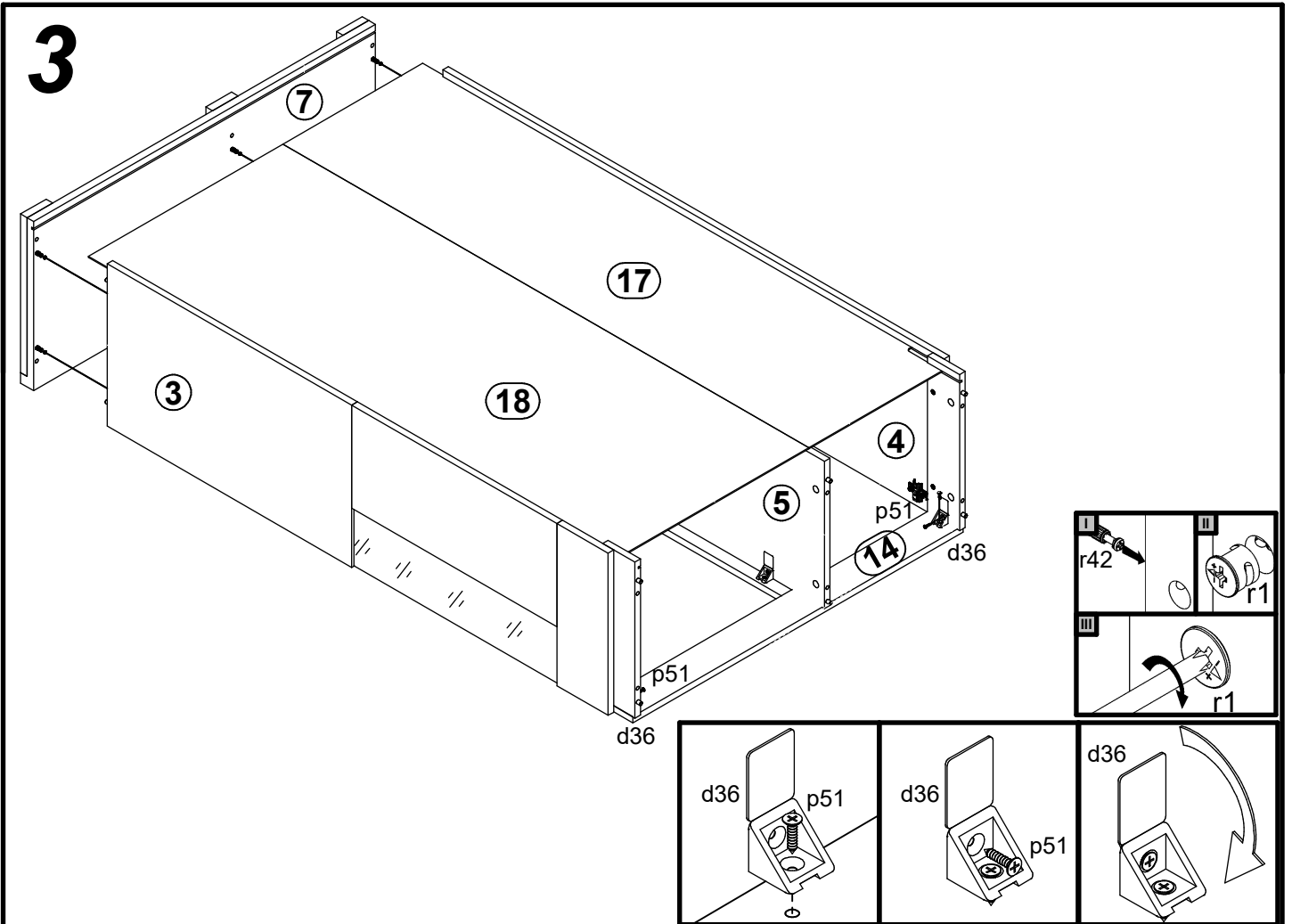

4

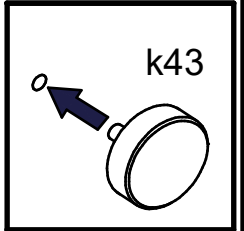
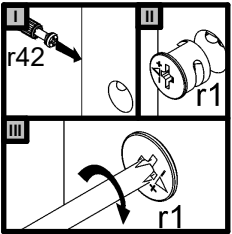
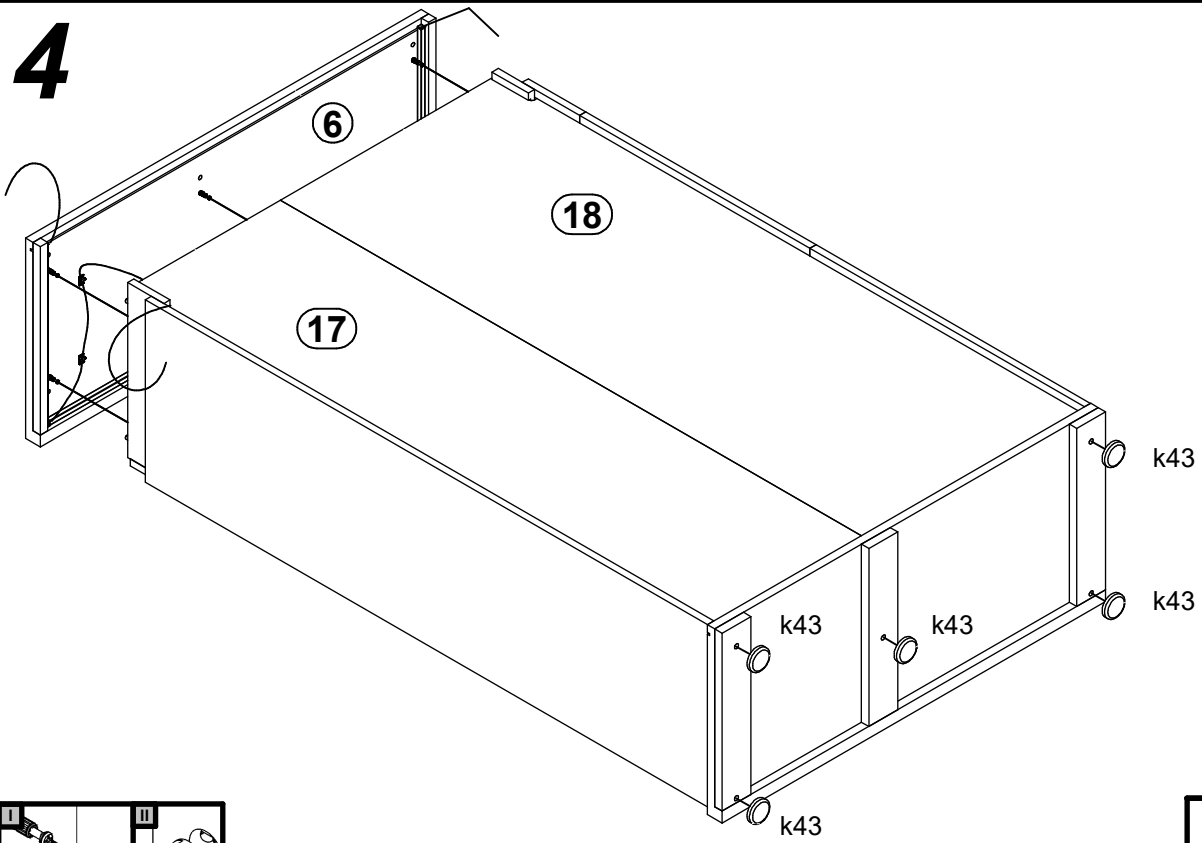

5

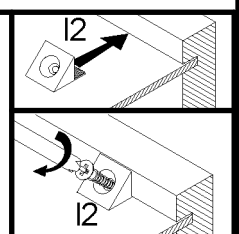
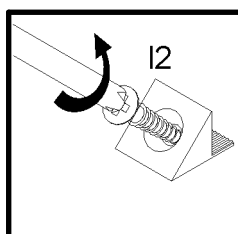
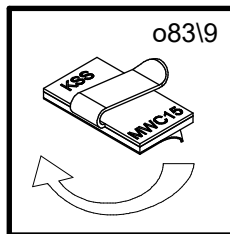
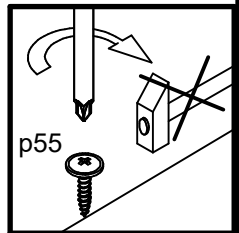
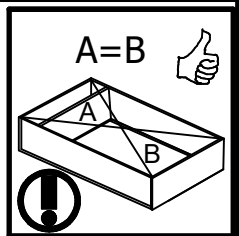
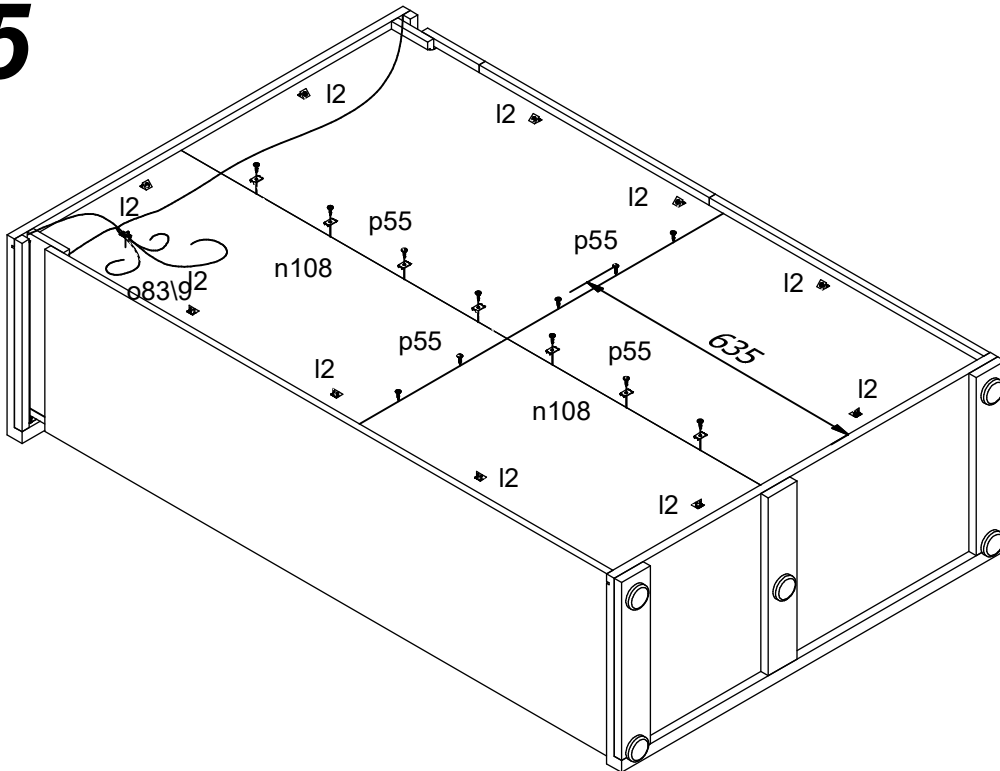

6

